

ADDENDUM NO. 1

TO

Bid

Venetia Valley Building H Roofing Project

Bid # 23-11

Addendum Date: 5/24/2023

Item 1-1: **Question 1:** Looking at your project in Blue Book Construction. I see there is a bid walk on May 17. I do not see any specifications yet. Can you tell me what type of roofing will be installed on this project?

Response: The information is on our website: <https://www.srcsbondprogram.org/domain/16>

Item 1-2: **Question 2:** Can you please advise when is this job is expected to start?

Response: It is anticipated that the contract will be approved by the Board June 12, 2023. The project can start following Board approval.

Item 1-3: **Question 3:** Is a bond or prequalification required to this project.

Response: Thank you for your interest. Information can be found in the Notice to Bidders and associated documents located on our website <https://www.srcsbondprogram.org/domain/16>

Item 1-4: **Question 4:** “gutter & downspout?” I need specs.

Response: See sheet A1.2/1 for gutter details and specifications included in Addendum 1.

Item 1-5: **Question 5:** Are you the GC?

Response 5: San Rafael City Schools is a school district.

Question 5A: Do I give the bid to you on 6-2-2023?

Response 5A: The information can be found in the Notice to Bidders.

Question 5B: Do I needed “bid bond” on this job, or carry by you?

Response 5B: All bonds are to be carried by the contractor as specified in in the Notice to Bidders and associated documents located on our website <https://www.srcsbondprogram.org/domain/16>.

Question 5C: Re-roof permit by you?

Response 5C: Any permits required are provided by the contractor. Please refer to documents located on our website <https://www.srcsbondprogram.org/domain/16>.

Question 5D: Demo & re-roof composition shingle only?

Response 5D: That information can be found in the Notice to Bidders and associated documents located on our website <https://www.srcsbondprogram.org/domain/16>

Question 5E: Or alternate “gutter & downspout?” I need specs.

Response 5E: Refer to Item 1-4 Response.

Item 1-6: **Question 6:** In Section: 07-31-10 Asphalt Shingles did not mention about install (N) ½” cover board adhered to 1” rigid insulation set in sealant, but detail did called out. Please let me know if my price include rigid – details (1; 2; 9; 11 & 19) or without rigid – details (4 & 12)?

Response: Pricing should be inclusive of all items. Please refer to information can be found in the Notice to Bidders and associated documents located on our website <https://www.srcsbondprogram.org/domain/16>.

Item 1-7: **Question 7:** In Section: 07-31-10 Asphalt Shingles did not mention about install (N) ½” cover board adhered to 1” rigid insulation set in sealant but detail did called out.

Response 7: Section 07 21 00 Thermal Insulation specification is included in Addendum 1.

Question 7A: Please let me know if my price include rigid – details (1; 2; 9; 11 & 19) or without rigid – details (4 & 12)?

Response 7A: Pricing should be inclusive of all items. Please refer to information can be found in the Notice to Bidders and associated documents located on our website <https://www.srcsbondprogram.org/domain/16>

Question 7B: May I use 1-1/2” nail board with hunter nails on this job

Response 7B: See sheet A1.2/19 for option to use 1-½" nail board.

Item 1-8: **Question 8:** Does fascia board need to be replaced?

Response: The fascia board is to be replaced to accommodate insulation. See sheet A1.2/1 and A1.2/4 is included in Addendum 1.

Item 1-9: **Question 9:** What is the bid opening link?

Response:
<https://us06web.zoom.us/j/81387166228?pwd=ZmtES3crcDRBUTIMako2KzVtRmtKUT09>

END OF ADDENDUM

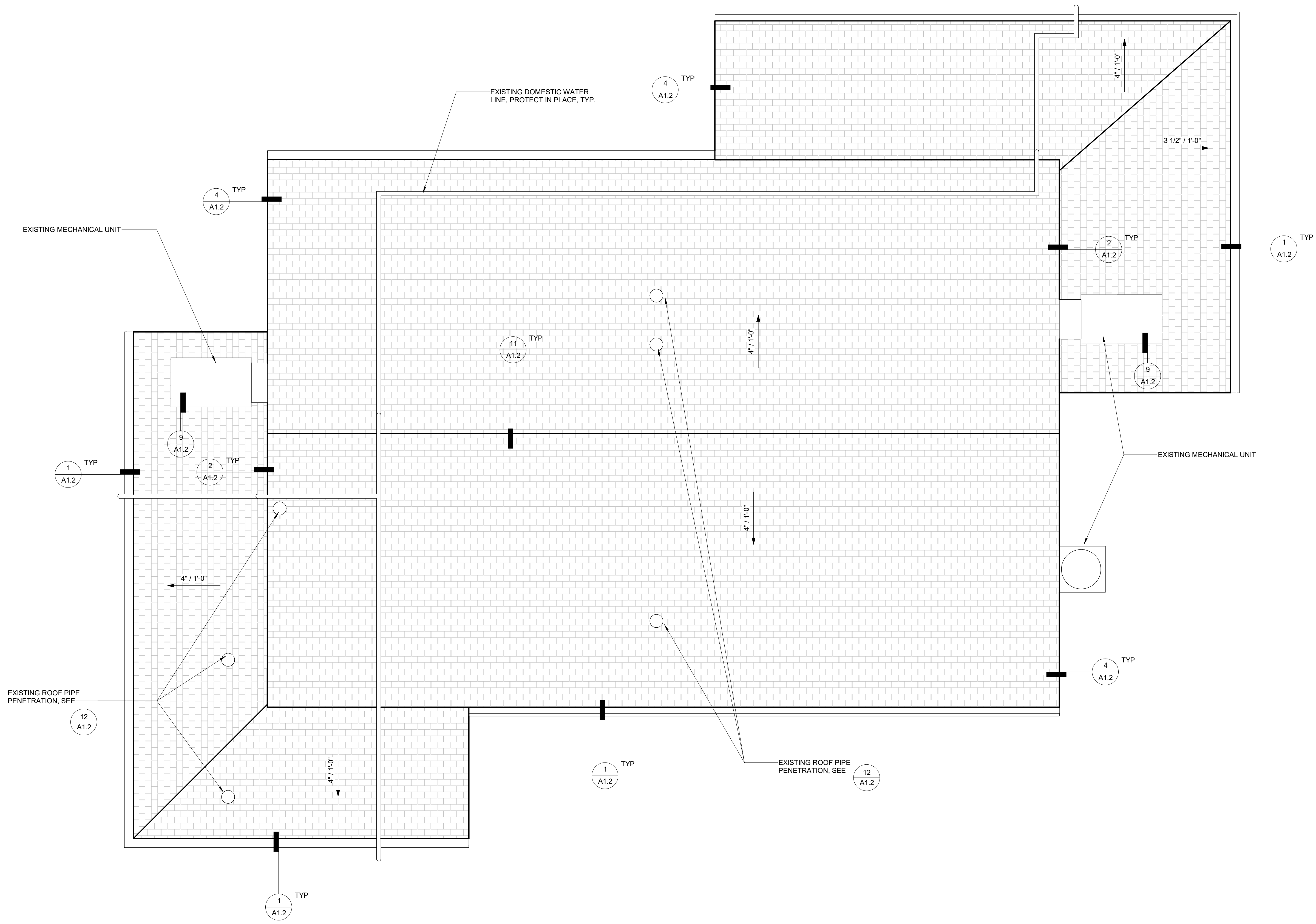

- DEMOLITION SCOPE SHALL CONSIST OF:
1. REMOVAL OF ALL EXISTING SHINGLE ROOFING AND UNDERLAYMENT TO EXPOSED DECK.
 2. REMOVAL OF ALL EXISTING FASCIA, GUTTERS AND EDGE FLASHING AT RAKES AND EAVES.
 3. REMOVAL OF EXISTING PIPE FLASHING.
 4. PROTECT IN PLACE ALL EXISTING MECHANICAL EQUIPMENT, VENTS AND PIPES.

DEMOLITION SCOPE

- NEW ROOFING SCOPE SHALL CONSIST OF:
1. NEW SYNTHETIC UNDERLAYMENT TO EXISTING DECK THROUGHOUT.
 2. NEW FLASHING AT ALL ROOF EDGES AND BASE FLASHING AT WALLS.
 3. NEW GUTTERS.
 4. NEW PIPE FLASHING AT ALL EXISTING VENTS AND CONDUITS THROUGH ROOF.
 5. REPAIR, RESEAL, AND REFINISH ALL (E) WOOD FASCIA

NEW ROOFING SCOPE

OWNER: SAN RAFAEL CITY SCHOOLS

PROJECT NAME: VENETIA VALLEY BLDG H
ROOFING DEMOLITION AND
REPLACEMENT

CLIENT ADDRESS: 177 N San Pedro Rd, San Rafael, CA 94903

REVISIONS:		
	DESCRIPTION	DATE
1	Addendum	5/25/23

PROJECT NO: 2023-40119

DATE ISSUED: MM/DD/YY

SCALE: 1/4" = 1'-0"

SHEET NUMBER: A1.1

SHEET TITLE:

ROOF PLAN

6 HUTTON CENTRE DR, SUITE 1150 SANTA ANA, CA 92707
T 949.809.3380 WWW.SVA-ARCHITECTS.COM

THIS DOCUMENT CONTAINS INFORMATION PROPRIETARY TO SVA ARCHITECTS INC. AND IS FURNISHED IN CONFIDENCE FOR THE LIMITED PURPOSE OF EVALUATION, REVIEW, OR REVISION. THIS DOCUMENT OR ITS CONTENTS MAY NOT BE USED FOR ANY OTHER PURPOSE AND MAY NOT BE REPRODUCED OR DISCLOSED TO OTHERS WITHOUT THE PRIOR WRITTEN CONSENT OF SVA ARCHITECTS INC. ALL RIGHTS RESERVED. © COPYRIGHT 2018.

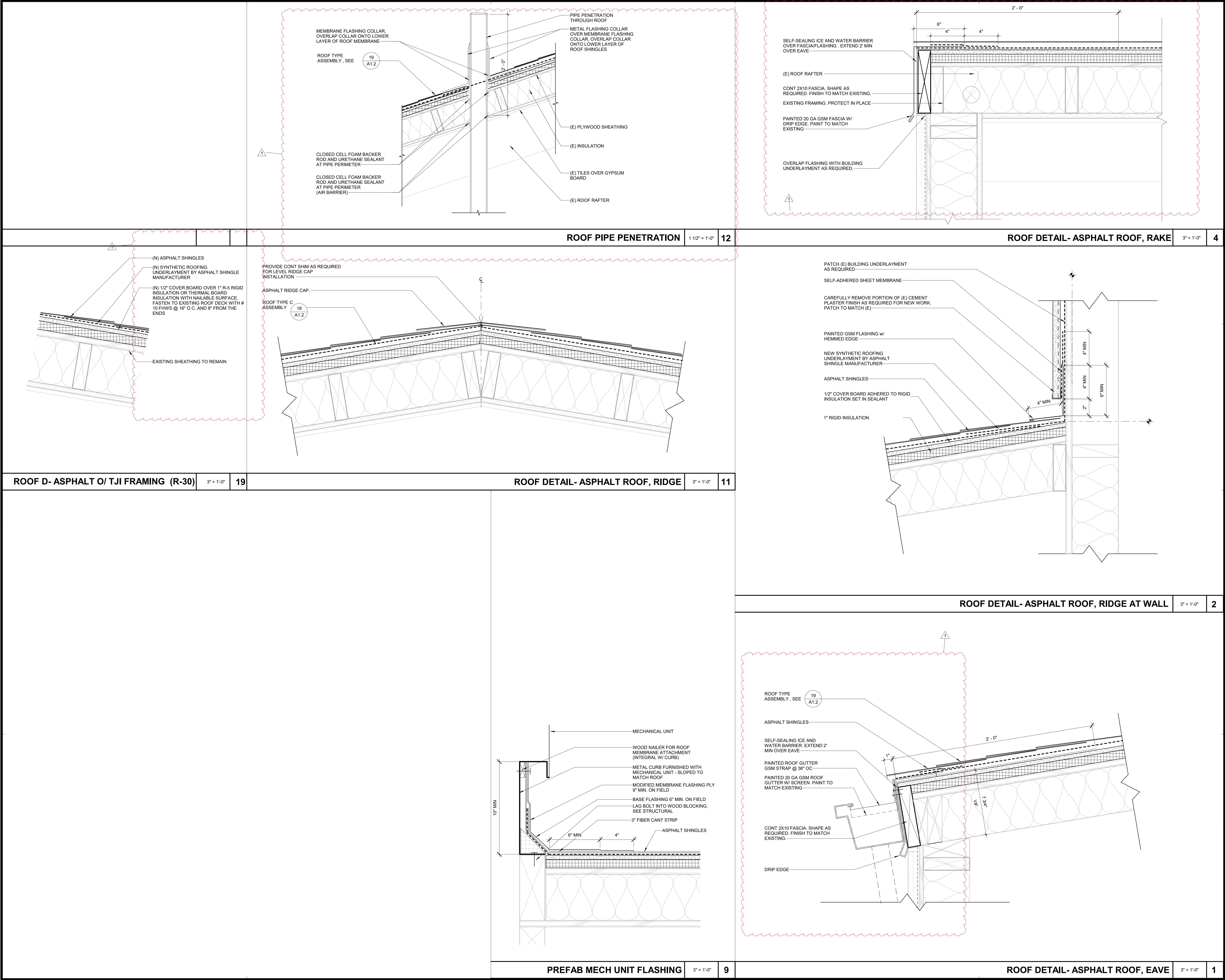

OWNER: SAN RAFAEL CITY SCHOOLS

PROJECT NAME: VENETIA VALLEY BLDG H
ROOFING DEMOLITION AND REPLACEMENT

CLIENT ADDRESS: 177 N San Pedro Rd, San Rafael, CA 94903

REVISIONS:		
	DESCRIPTION	DATE
1	Addendum	5/25/23

PROJECT NO: 2023-40119

DATE ISSUED: MM/DD/YY

SCALE: As indicated

SHEET NUMBER: A1.2

SHEET TITLE:

ROOF DETAILS

SECTION 00 01 10

TABLE OF CONTENTS

**PROJECT MANUAL
INTRODUCTORY INFORMATION**

Section	00 01 10	Table of Contents
	00 72 00	General Conditions 2017

SPECIFICATIONS GROUP

DIVISION 1 – GENERAL REQUIREMENTS

Section	01 11 00	Summary of Work Remodel
	01 25 00	Substitution Procedures w Request Form
	01 30 00	Administrative Requirements
	01 31 00	Project Management and Coordination
	01 40 00	Quality Requirements
	01 50 00	Temporary Facilities and Controls Remodel
	01 60 00	Product Requirements
	01 70 00	Execution Requirements
	01 73 00	Cutting and Patching
	01 74 10	Waste Management
	01 77 00	Closeout Procedures
	01 78 00	Warranties

DIVISION 2 – EXISTING CONDITIONS

Section	02 41 20	Selective Building Demolition
---------	----------	-------------------------------

DIVISION 6 – WOOD, PLASTICS, AND COMPOSITES

Section	06 10 50	Miscellaneous Rough Carpentry
	06 20 00	Finish Carpentry

DIVISION 7 – THERMAL AND MOISTURE PROTECTION

Section	07 21 00	Thermal Insulation
	07 28 00	Weather Barrier Underlayment
	07 31 10	Asphalt Shingle
	07 60 00	Flashing and Sheet Metal
	07 90 00	Joint Sealants

DIVISION 9 – FINISHES

Section	09 01 20	Plaster Patching
	09 90 00	Painting and Coating

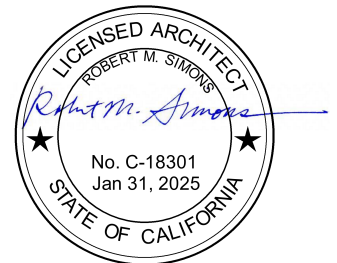

SECTION 07 21 00

THERMAL INSULATION

PART 1 - GENERAL

1.1 SUMMARY

- A. Section Includes: Provide insulation and accessories as required for complete installation.
 - 1. Provide nailable surface polyisocyanurate thermal board roof insulation.
- B. Related Work:
 - 1. Section 07 31 00: Asphalt Shingle

1.2 ADMINISTRATIVE REQUIREMENTS

- A. Interior Vapor Retarders: Where specifications require foil faced vapor retarders as part of building thermal insulation system, intent is to prevent migration of spores from mold and mildew into interior building spaces.
 - 1. Intent is to provide air barrier and vapor retarder on interior surface while allowing vapor to move through exterior wall vapor permeable surfaces, while vapor permeable water barriers are maintained at exterior side of wall.

1.3 SUBMITTALS

- A. Product Data: Furnish manufacturer's literature for each type of insulation.
 - 1. Submit Underwriter's Laboratory approval numbers for required fire ratings; approvals of other laboratories contingent upon acceptance of applicable authorities.

1.4 QUALITY ASSURANCE

- A. Sustainability Requirements: Comply with CALGreen requirements including those relative to energy efficiency.

PART 2 - PRODUCTS

2.1 MATERIALS

- A. System Description: Provide thermal insulation with accessories.

- B. Thermal Board Insulation with Nailable Surface: Provide foam insulation intended for use with sloped nailable type roofing systems; with minimum 7/16" oriented strand board (OSB) surface and glass fiber mat facer, conform to ASTM C1289, Type V.
 - 1. Manufacturers:
 - a. Johns Manville/NailBoard.
 - b. Dow Chemical Co./Hy-Therm Nail-Line.
 - c. Atlas Roofing Corp./ACFoam Nail Base.
 - d. RMAX, Inc./Nailable Base-3.
 - e. Substitutions: Refer to Section 01 25 00.
 - 2. Thermal Resistance: Not less than R-38 total Long-Term Thermal Resistance (LTTR) unless otherwise indicated.
- C. Accessories: Furnish as recommended by insulation manufacturer for insulation types, substrates, and conditions involved.
 - 1. Fasteners and Attachment Devices: Comply with insulation manufacturer recommendations for attachment of insulation.
 - 2. Fasteners to withstand loads specified for system.
 - 3. Vapor Retarder Tape: Minimum 2" wide self-adhering type designed to maintain vapor retarder integrity and complying with fire resistance ratings as required by applicable codes.
 - 4. Penetration Type Insulation Supports: Galvanized or electroplated steel penetration supports with adhesive attachment to substrate and support disc.
 - 5. Hat Channels for Special Fibrous Continuous Insulation: Types as indicated and as recommended by insulation manufacturer for applications indicated.
 - 6. Thermal Break Insulation Supports for Continuous Insulation: Provide attachment system designed specifically for supporting both continuous insulation and exterior building cladding systems indicated.
 - a. Manufacturers:
 - 1) Armatherm (844.360.1036)/Armatherm Z Girt Structural Thermal Break.
 - 2) Knight Wall Systems (855.597.9255)/CI or HCI System.
 - 3) Substitutions: Refer to Section 01 25 00.
 - b. Provide system recommended by manufacturer for applications indicated with accessories as required for complete thermally-broken continuous insulation system in configurations indicated.

PART 3 - EXECUTION

3.1 EXAMINATION

- A. Verify substrate and adjacent materials are dry and ready to receive insulation; beginning installation signifies acceptance of conditions.

- B. Ensure mechanical and electrical items affecting work are properly placed, complete, and have been inspected by Architect prior to commencement of installation.

3.2 INSTALLATION

- A. General: Install insulation in accordance with manufacturer's instructions and applicable code requirements. Cut and trim insulation neatly, to fit spaces.
 - 1. Fit insulation tight within spaces and tight to and behind mechanical and electrical services within insulation plane; leave no gaps or voids; maintain integrity of thermal barrier.
 - 2. Backed Insulation: Use insulation free of ripped backs and edges.
 - 3. Insulations with Vapor Retarder Facing: Install insulation with integral vapor retarder with vapor retarder toward inside of building.
- B. Batt Insulation: Friction fit batt insulation in place; use tape or penetration supports as necessary to assure permanent installation.
 - 1. Taping: Tape joints and tears in integral vapor retarder, including joints between insulation and surrounding construction, to ensure vapor-tight installation.
 - 2. Taping: Tape tears in integral vapor retarder.
 - 3. Penetration Supports: Cut or bend pins in locations accessible to maintenance personnel, to eliminate potential hazards from exposed pin points.
- C. Nailable Surface Roof Insulation: Secure using fasteners recommended by insulation manufacturer for application indicated and capable of resisting wind loads specified for roofing systems applied over nailable surfaced roof board insulation.
- D. Blown-In Insulation: Apply in accordance with manufacturer's instructions to achieve specified thermal resistance and monolithic blanket of uniform density.
 - 1. Assure clips, hangers, supports, sleeves, and other items installed within insulation space are in place before applying insulation.
 - 2. Remove excess, overspray, droppings and debris.
- E. Spray-Foam Insulation: Apply in accordance with manufacturer's instructions to achieve specified thermal resistance and uniform coverage and density.
 - 1. Assure clips, hangers, supports, sleeves, and other items installed within insulation space are in place before applying insulation.
 - 2. Remove excess, overspray, droppings and debris.
- F. Spray-On Insulation: Apply in accordance with manufacturer's instructions to achieve specified thermal resistance, complete adherence to substrate, and monolithic blanket of uniform density.

1. Verify bond requirements and compatibility of substrates; use recommended procedures to minimize unsafe conditions.
 2. Clean substrate of dirt, dust, grease, oil, loose particles and materials which could adversely affect bond of insulation.
 3. Assure clips, hangers, supports, sleeves, and other items penetrating insulation are in place before applying insulation.
 4. Protect applied insulation from construction operations and patch as needed to maintain thermal value.
 5. Remove excess, overspray, droppings and debris.
 6. Apply sealer to materials exposed in finished construction and where recommended by manufacturer or required by applicable codes.
- G. Continuous Insulation Installation: Comply with manufacturer recommendations and installation instructions for continuous insulation for use in systems indicated.
- H. Separate Vapor Retarder: Install vapor retarder in accordance with manufacturer's recommendations and installation instructions for complete vapor retarder installation.
1. Tape joints and tears in vapor retarder.
 2. Seal vapor retarder to penetrations.

END OF SECTION